

Ansicht A / View A

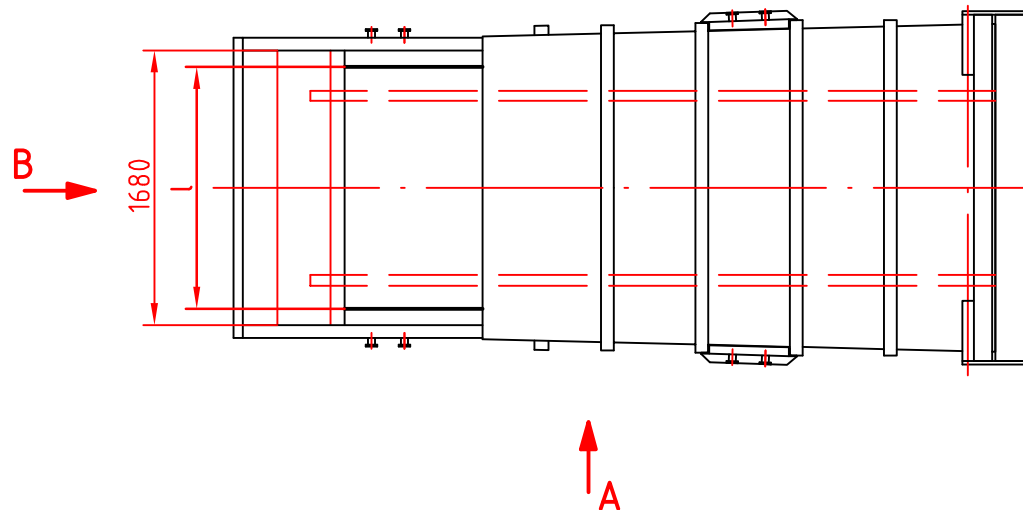

Ansicht B / View B

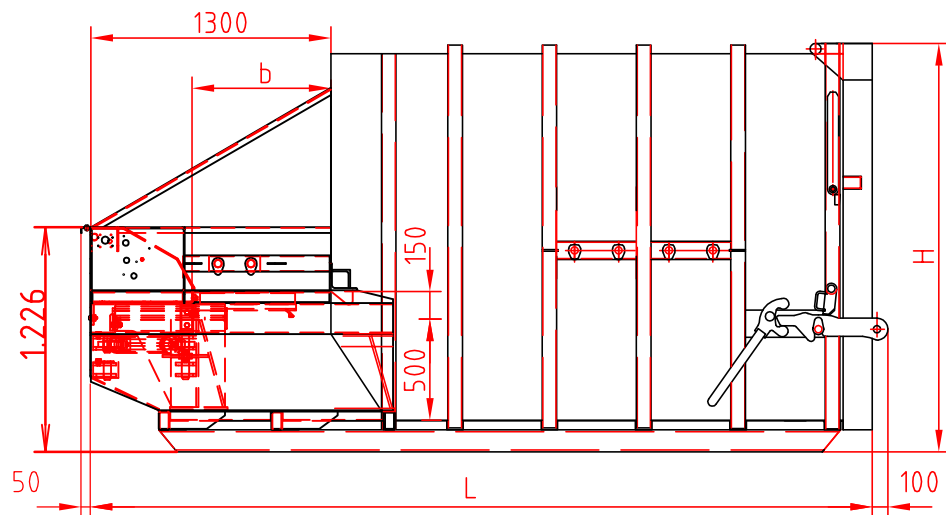
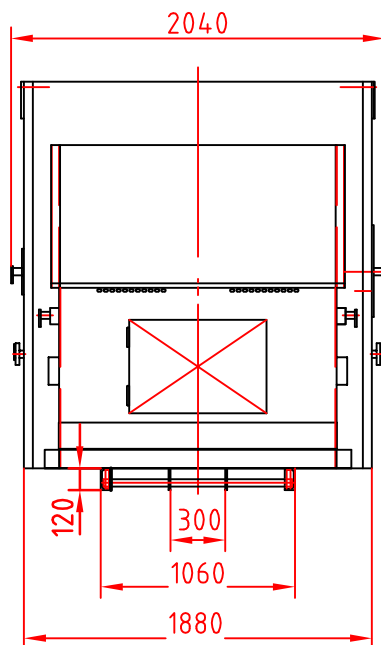

**PRESTO**  
for your pressing issues

| Selbstpreßcontainer Typ HAN                   |                   |  |       |        |        |
|---|-------------------|--|-------|--------|--------|
| mobile compactor type HAN                     |                   |  |       |        |        |
| Typ / type                                    |                   | HAN 6  | HAN 8 | HAN 10 | HAN 12 |
| Inhalt / volume                               | m <sup>3</sup>    | 6  | 8     | 10     | 12     |
| Länge L / length L                            | mm                | 3750   |       | 4350   | 4550   |
| Höhe H / height H                             | mm                | 2050   | 2250  |        | 2450   |
| Einfüllöffnung lxb / charge opening lxb       | mm                | 1500 x 750   |       |        |        |
| Preßkraft / compacting force                  | kN                | 250  |       |        |        |
| spez. Preßkraft / spec. compacting force      | kN/m <sup>2</sup> | 333  |       |        |        |
| Taktzeit / cycle time                         | s                 | 25   |       |        |        |
| Maschinengewicht ca. / machine weight approx. | kg                | 2200   | 2300  | 2500   | 2700   |
| Motorleistung / motor rating                  | kW                | 5,5  |       |        |        |
| Elektroanschluss / electrical requirement     |                   | 400V,50Hz,CEE-Stecker,32A,5-polig<br>400V,50Hz,CEE-plug,32A,5-pole |       |        |        |

Stand September 2011 Technische Änderungen vorbehalten.